



April 2nd, 2026

Hopkins County Courthouse  
118 Church St  
Sulphur Springs, TX 75482

**New Overhead Installation at 3383 CR 1103 Sulphur Springs 75482**  
**Project Number: 31983058**

Greetings,

Oncor Electric Delivery LLC., is requesting permission to do work within the county right of way along CR 1103. We are looking to install a 40/3 WP & 25kVA 120/240V transformer in ROW to serve a customer at 3383 CR 1103.

Site location map and construction work prints are enclosed. The work print details the proposed work.

If you have any questions, please contact me at any time.

Sincerely,

*Grayson Griffin*  
Designer  
Grayson.Griffin@Oncor.com  
Phone: (469) 822-5042

County Approval Section:

Approved:  Denied:

Authorized Signature: *W. Griffin* Date: 4-13-2026

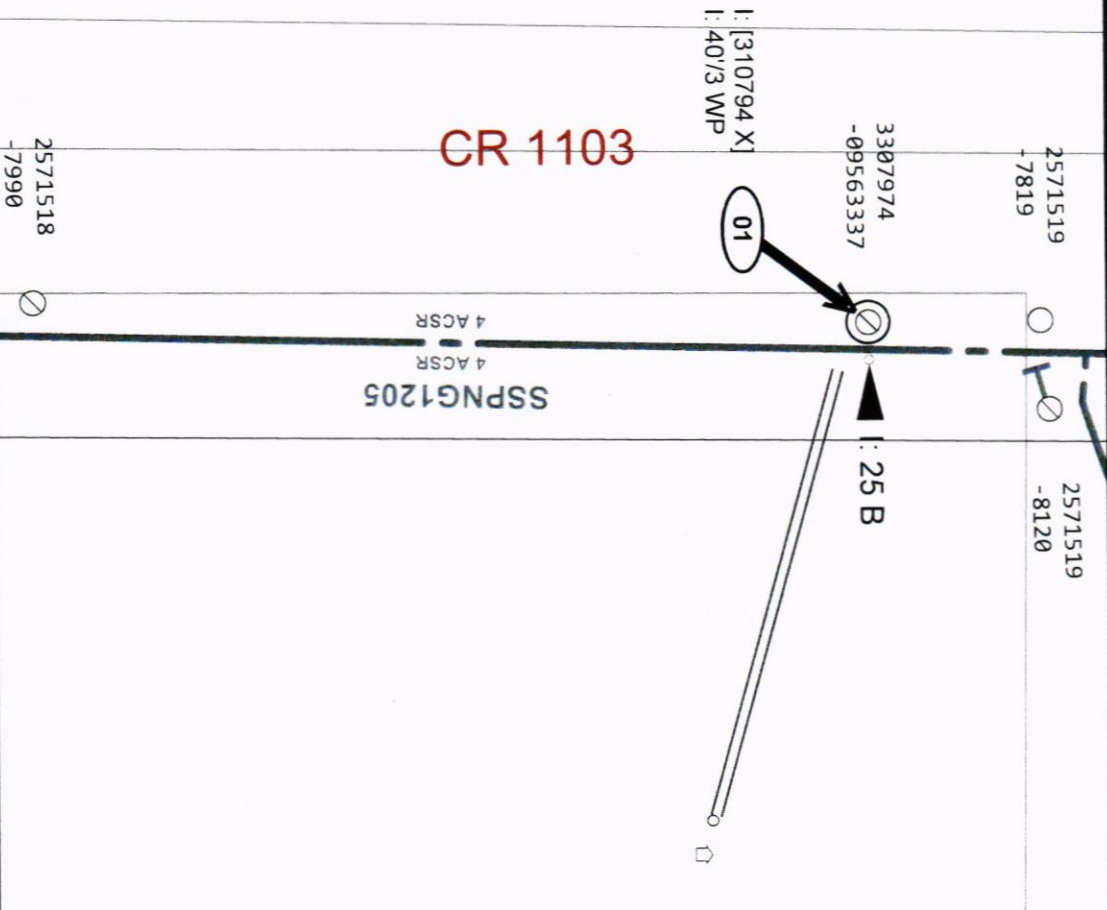

Installing new 40/3 WP  
in county ROW  
GPS:  
(33.079739, -95.633400)

# ELECTRIC CONSTRUCTION PRINT

WO Number: **31983058-01** Date: 2026/04/01 Description: Jami Davis - 3383 Co Rd 1103, Sulphur Springs, TX 75482

Sheet: **1** of Scale: 1"=20' Customer:

Job Status: Design Svc Ctr / Office: SUL/ Address: 3383 Co Rd 1103 SULPHUR SPRINGS

Designer: **GRIFFIN, GRAVSON J/U877** 469-822-5042 Location:  
Project Mgr: **GRIFFIN, GRAVSON J/U877** 469-822-5042

Copyright 2018 Oncor Electric Delivery. Maps, drawings, and electronic data (products) are created for the internal purposes of Oncor Electric Delivery with no implication of suitability or fitness for the intended use of the recipient. Oncor Electric Delivery and its affiliates do not warrant the accuracy or quality of such products. The locations shown are approximations and are not intended to show exact locations. Products provided to other parties by Oncor Electric Delivery are for the internal use of the recipient, and the recipient agrees not to duplicate or distribute the products or any portion of the products to third parties without the prior written permission of Oncor Electric Delivery. The recipient further agrees to hold harmless and indemnify Oncor Electric Delivery against all claims, costs, expenses and damages resulting from or predicated upon strict liability for personal injuries, death or property damage, on account of any defect in the property provided hereunder.